

Resident Camp Packing List

*****LABEL EACH ITEM WITH CAMPER'S NAME*****

CLOTHING

- Shirts
- Shorts
- Pajamas
- Undergarments
- Socks
- Warm jacket/sweatpants
- Rain jacket and boots
- Laundry Bag
- Bathing suits
- Sunglasses
- Closed-toed shoes that attach around the ankle or heel (ie. crocs or old sneakers)
- Banquet attire - informal, (ie. sundress, khakis, polo shirt, etc.)



ESSENTIALS

- Pool Towel
- Insect Repellent
- Sunscreen
- Water Bottle
- Masks
- Flashlight and/or headlamp
- A small bag to carry items between classes
- Quiet, rest hour activity - ie. book, journal, sketch pad, etc.
- Stationary –Pre-addressed envelopes, stamps, & pen
- Prescribed medications - Must be in original packaging along with written directions from the doctor for administration

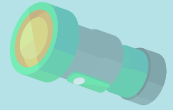

BATH HOUSE

- Bath Towel(s) & washcloth
- Toothbrush & toothpaste
- Comb/Brush
- Shampoo, soap, conditioner
- Shower caddy or toiletries bag
- Shower/Pool shoes

DO NOT BRING

- ❌ PETS
- ❌ CASH
- ❌ GUM
- ❌ FOOD
- ❌ Electronic devices including smartwatches, tablets, and (especially) cell phones.

CABIN SUPPLIES

- Pillow
- Twin-size bed linens
- Sleeping bag and/or blanket
- Trunk, duffel bag, or small set of plastic drawers for storing belongings.



CAMP WRIGHT IS NOT RESPONSIBLE FOR LOST, STOLEN, OR DAMAGED ITEMS THAT ARE BROUGHT TO CAMP. LOST AND FOUND ITEMS ARE COLLECTED AND DISPLAYED EACH DAY DURING CAMP.